

## Watton Road, Great Ellingham, NR17

£415,000

3 1 2



Moneyproperties bring to market this spacious three-bedroom detached bungalow occupying a generous plot on the outskirts of the popular village of Great Ellingham. This spacious bungalow comprises of an entrance porch, 18ft dual aspect living room with feature fireplace, open plan kitchen/diner, 20ft conservatory overlooking the rear garden along with three double bedrooms, bathroom with separate bath and shower and a wc. To the outside the property enjoys a large rear garden enjoying countryside views, carport, and two garages, a good-sized garden and driveway providing ample off-road parking along with solar panels to the roof.

**Tenure: Freehold EPC: D Council Tax: D**

## Key Features

- Spacious three double bedroom detached bungalow
- Located on the edge of the popular village of Great Ellingham
- 18ft dual aspect living room with feature fireplace
- Benefiting from solar panels to the roof
- Offered with no-onward chain.
- Occupying a generous plot with a large front and rear garden
- The property enjoys countryside views throughout
- Open plan kitchen/diner leading to the 20ft conservatory
- Two single garages, carport and ample off-road parking
- See our full online listing for further details including flood risk, broadband speed and other material information.

### GROUND FLOOR

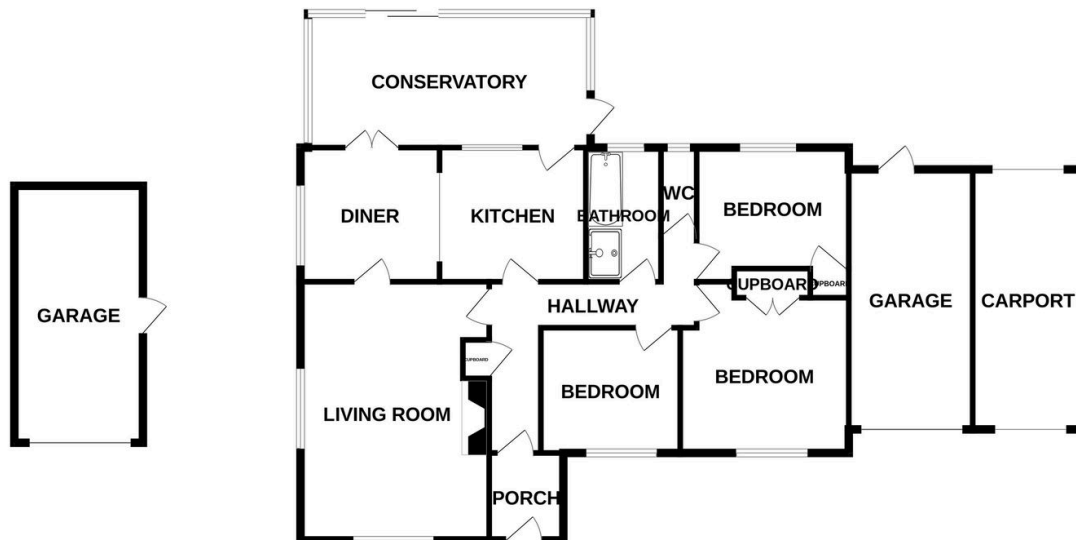

Whilst every attempt has been made to ensure the accuracy of the floorplan contained here, measurements of doors, windows, rooms and any other items are approximate and no responsibility is taken for any error, omission or mis-statement. This plan is for illustrative purposes only and should be used as such by any prospective purchaser. The services, systems and appliances shown have not been tested and no guarantee as to their operability or efficiency can be given.  
Made with Metropix ©2024